

Spa Light

CREATE SENSES AND SIGHT TO YOUR SPA

For spa and fiberglass pools



P50 Series Plastic Spa Light

LED-P50

Waterproof Standard Material

IP68 Plastic

Cable Installation

1.5m Wall mounted (housing type)

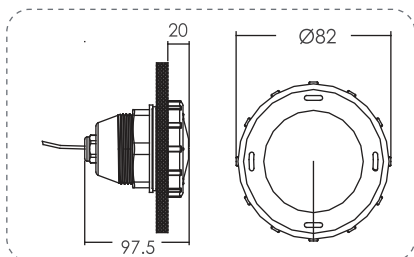

IP68 **CE** **RoHS**
COMPLIANT 2011/65/EU

P50 Series Light Product Information

Code	Model	Light	Watt/ Voltage	Color	Illuminance (lux)
88040101	UL-P50	MR 16 Halogen Lamp	20W/12V	Color lens (Red/Green/Blue)	200(red),260(green),100(blue),700(no lens)
88041101	LED-P50	MR 16, 18 LEDs Bulb	1W/12V	Auto Changing Color/Cool White/Blue	120(Color), 70(Cool White)

LED and halogen bulbs for P50 Series

Code	Model	Description	Watt/Voltage	Color
01173044	N/A	Concrete Housing for UL-P50	-	2-inch
04011016	N/A	MR16 Two-pin 18 LEDs Bulb	1W/12V	Auto Color Changing
04011015	N/A	MR16 Two-pin 18 LEDs Bulb	1W/12V	Cool White
04011001	N/A	MR16 Halogen Lamp	20W/12V	Color lens (Red/Green/Blue)



P10 Series Plastic Underwater Light

Waterproof Standard Material

IP68 ABS+ UV stabilizer

Cable Installation

3m Wall mounted
slip in 63mm Class 12 PVC pipe

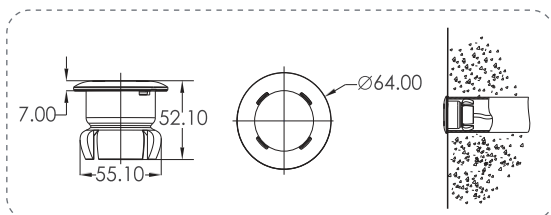

Code	Model	Description	Watt/Voltage	Color	Illuminance (lux)
88041939	LED-P10	18 LEDs Bulb for Concrete Pool	1W/12V	Auto Color Changing	124
88041940	LED-P10	18 LEDs Bulb for Concrete Pool	1W/12V	Cool White	170
9040003	LED-P10	18 LEDs Bulb for Concrete Pool	1W/12V	Warm White	180

EMAUX WATER TECHNOLOGY CO., LTD

ADDRESS G/F 41 TIN HAU TEMPLE ROAD,
NORTH POINT, HONG KONG
PHONE +852 2832 9880
www.emauxgroup.com

Pool & Spa Equipments

STRIVE FOR CLEAR WATER

Available from:

Chainaris Phuket Engineering Co., Ltd.
63/13 Moo.2, T.Vichit, A.Muang Phuket 83000
Tel: 076-513100-3 Fax: 076-513105
Line: @chainaris, @chainarishop



ALL SPECIFICATIONS ARE SUBJECT TO CHANGE WITHOUT NOTICE
© 2018 EMAUX WATER TECHNOLOGY CO., LTD. ALL RIGHTS RESERVED.