

CODIGO **06471**

DESCRIPCION: **SKIMMER 15L PP. B. STD. T. REDONDA TOR. PARKER**

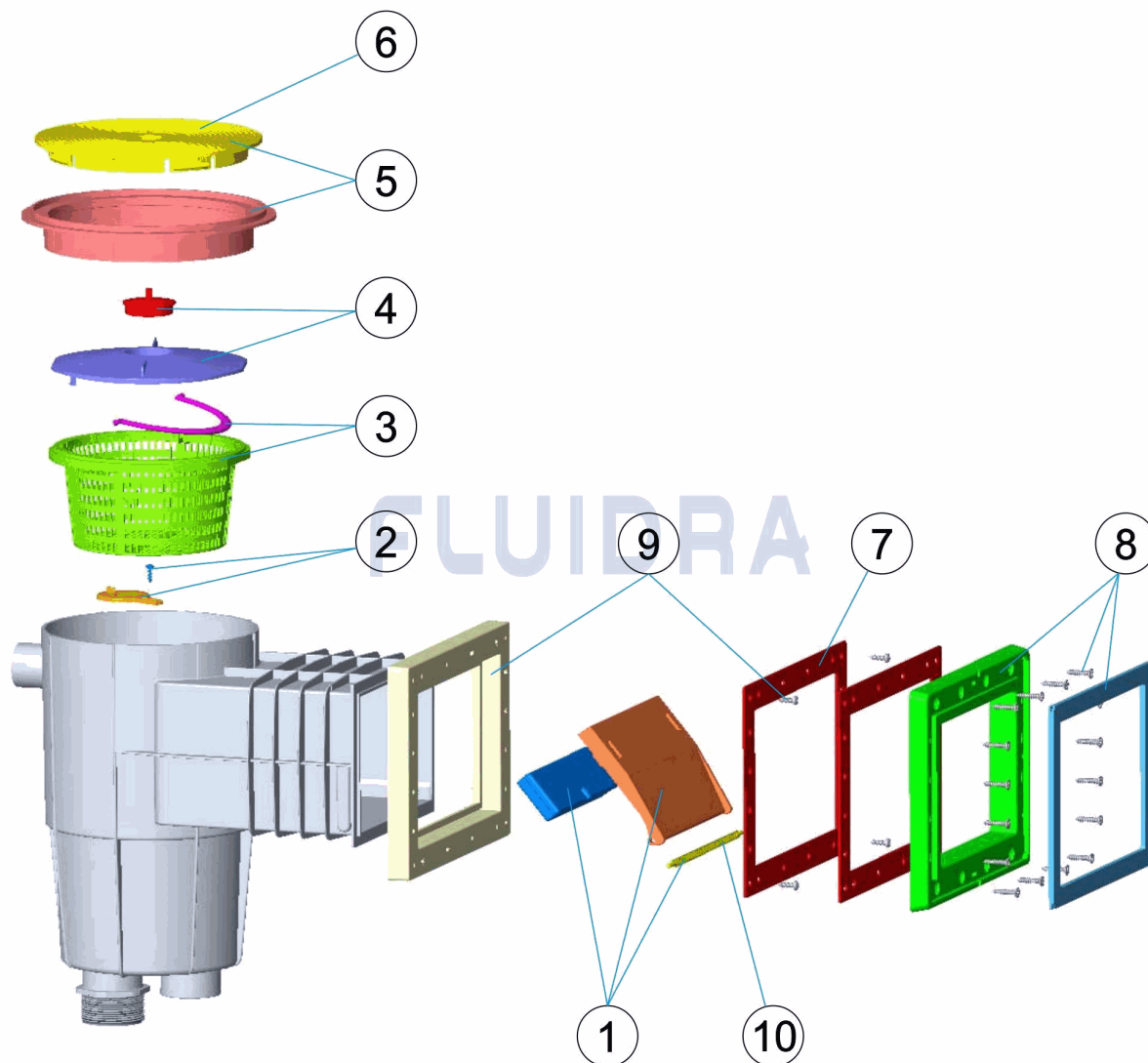

ESPAÑOL

POS	CODIGO	DESCRIPCION	CANTIDAD	POS	CODIGO	DESCRIPCION	CANTIDAD
1	4402010101	COMPUERTA SKIMMER BISAGRA	6	4402010108	TAPA CIRCULAR SKIMMER		
2	4402010102	CLAPETA SKIMMER	7	4402010307	JUNTA SKIMMER PEQUEÑA PISC. PREF.		
3	4402010103	CESTO SKIMMER	8	4402010312	MARCO PEQUEÑO SKIMMER (PARKER)		
4	4402010104	TAPA CESTO SKIMMER CON TAPON	9	4402010314	MARCO ADAPTADOR BOCA (PARKER)		
5	4402010105	TAPA Y ARO CIRCULAR SKIMMER	10	4402010110	BISAGRA COMPUERTA		

CODE **06471**

DESCRIPTION: **SKIMMER 15L PP. B. STD. C. ROND VIS. PARKER**

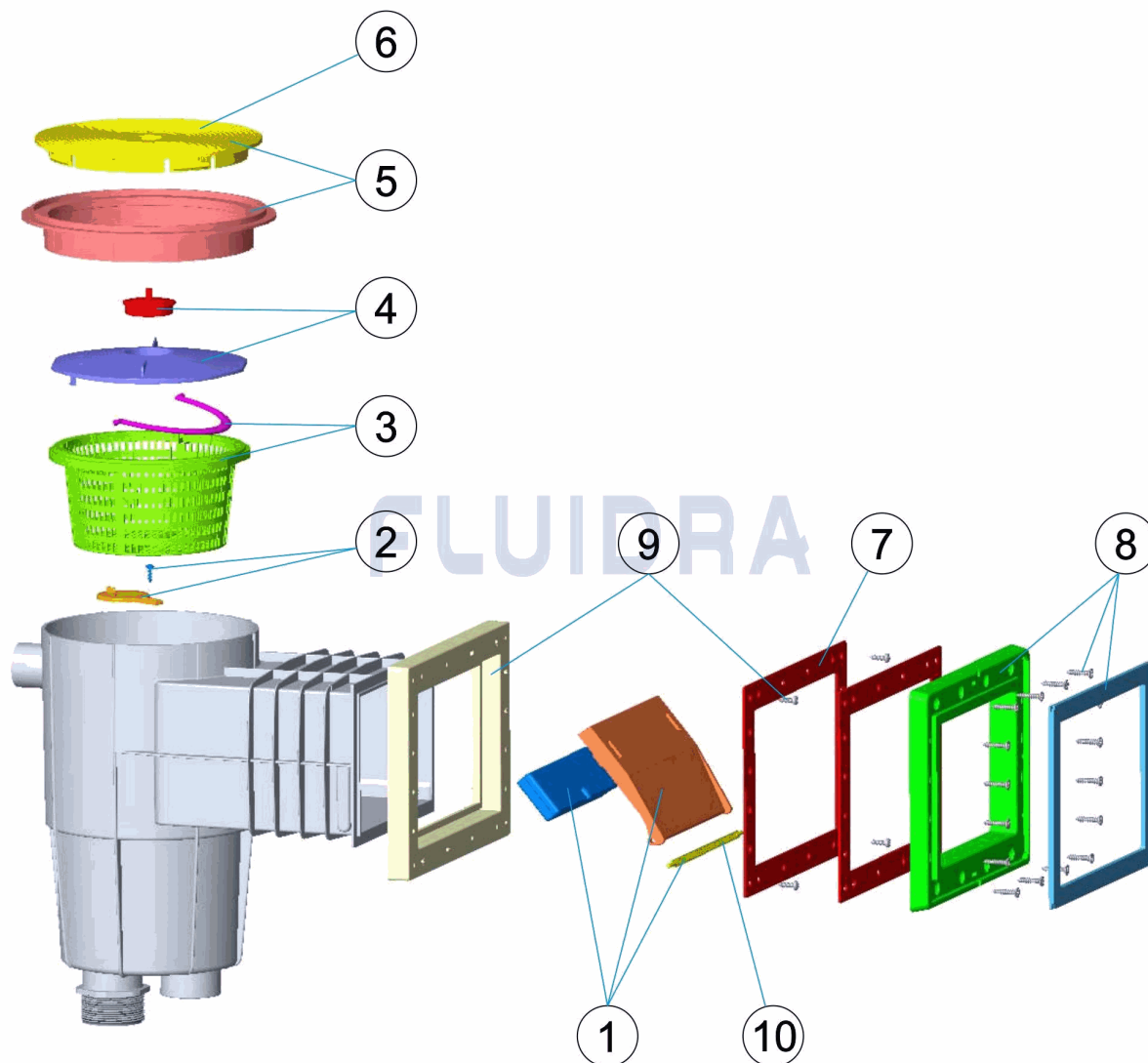

FRANCAIS

POS	CODE	DESCRIPTION	QUANTITE	POS	CODE	DESCRIPTION	QUANTITE
1	4402010101	VOLET ET CHARNIERE SKIMMER	6	4402010108	COUVERCLE ROND SKIMMER		
2	4402010102	CLAPET SKIMMER	7	4402010307	JOINT SKIM PETIT MODELE PISCINE LINER		
3	4402010103	PANIER SKIMMER	8	4402010312	PETIT CADRE SKIMMER (PARKER)		
4	4402010104	COUVERCLE PANIER SKIMMER AVEC BOU	9	4402010314	CADRE ADAPTEUR BOUCHE (PARKER)		
5	4402010105	COUVERCLE ET CADRE ROND SKIMMER	10	4402010110	CHARNIERE VOLET		

CODE **06471**

DESCRIPTION: **SKIMMER 15L PP. B. STD. ROUND COVER PARKER**

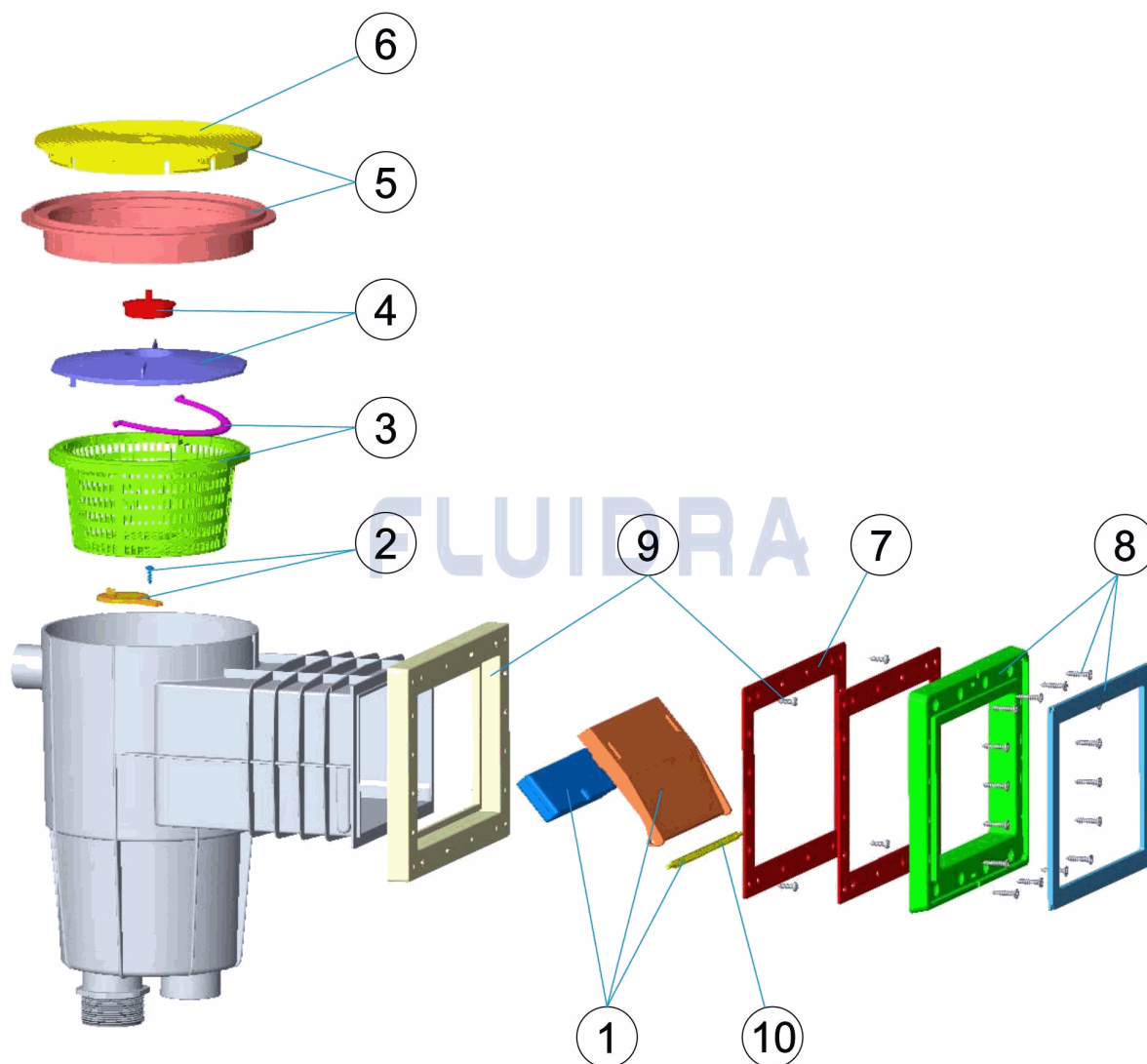

ENGLISH

POS	CODE	DESCRIPTION	QUANTITY	POS	CODE	DESCRIPTION	QUANTITY
1	44020101	FLAP RETAINING CLIP		6	4402010108	CIRCULAR SKIMMER LID	
2	44020102	KEYHOLE FLAP		7	4402010307	SMALL SKIMMER GASKETS FOR LINER PO	
3	44020103	SKIMMER BASKET		8	4402010312	SMALL SKIMMER FRAME (PARKER)	
4	44020104	VACUUM PLATE WITH PLUG		9	4402010314	ADAPTOR FRAME (PARKER)	
5	44020105	CIRCULAR LID AND LID FRAME		10	4402010110	HINGE FLAP	

CODICE 06471

DESCRIZIONE: SKIMMER 15L PP B. STD. T. ROTONDO TOR. PARKER

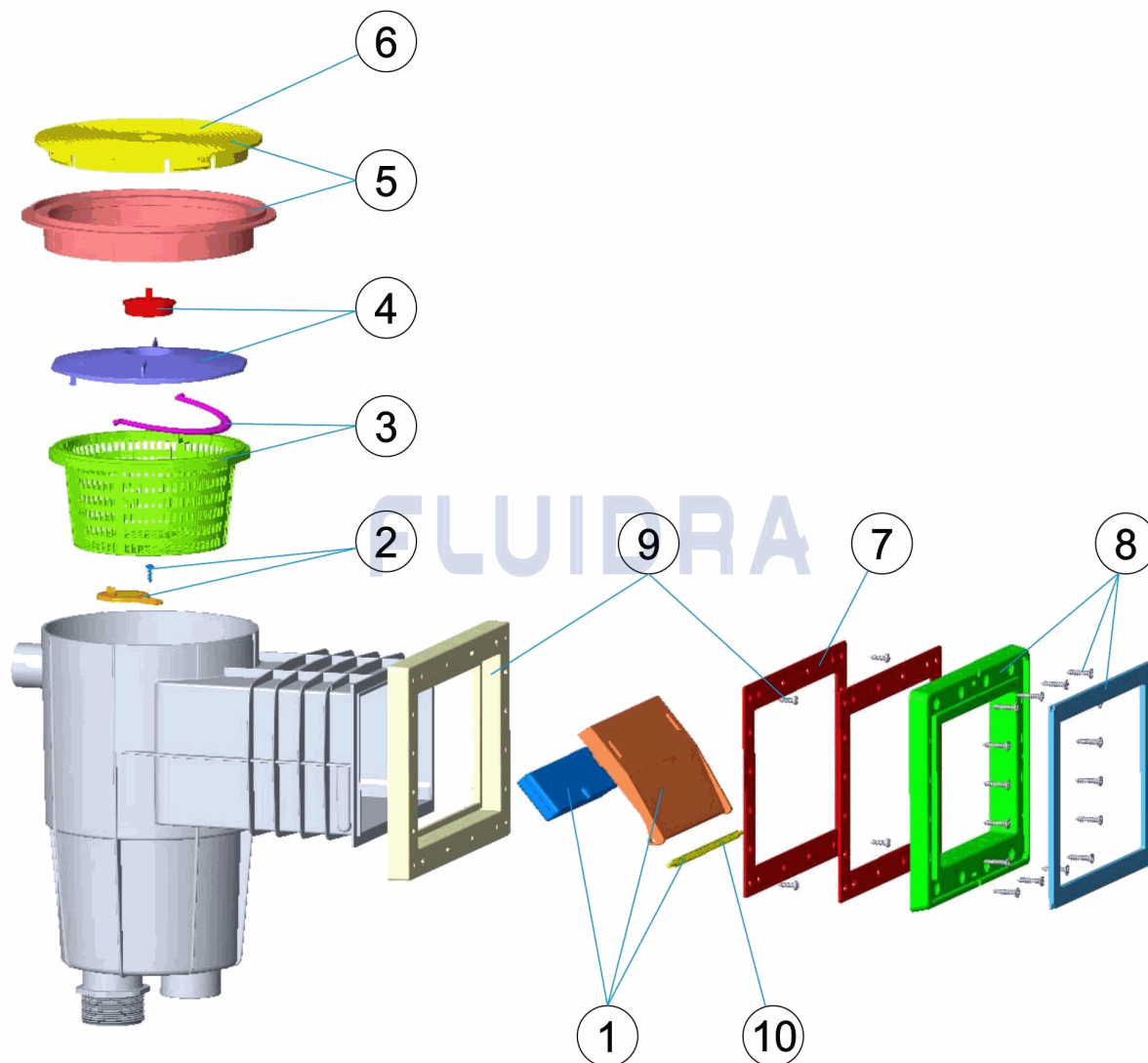

ITALIANO

POS	CODICE	DESCRIZIONE	QUANTITA'	POS	CODICE	DESCRIZIONE	QUANTITA'
1	4402010101	BATTENTE SKIMMER CON PERNO		6	4402010108	COPERCHIO TONDO SKIMMER	
2	4402010102	ALETTA PARZIALIZZATRICE SKIMMER		7	4402010307	GUARNIZIONE PER SKIMMER BASE P.F.	
3	4402010103	CESTELLO SKIMMER		8	4402010312	FLANGIA SKIMMER (PARKER)	
4	4402010104	COPERCHIO CESTELLO SKIMMER CON TA		9	4402010314	FLANGIA ADATTATORE BOCA (PARKER)	
5	4402010105	COPERCHIO E CORNICE TONDA SKIMMER		10	4402010110	CERNIERE BATTENTE	

CODE **06471**

BESCHREIBUNG: **SKIMMER 15L PP. EINLASS STANDARD ABDECKUNG RUND SCHRAUBE**

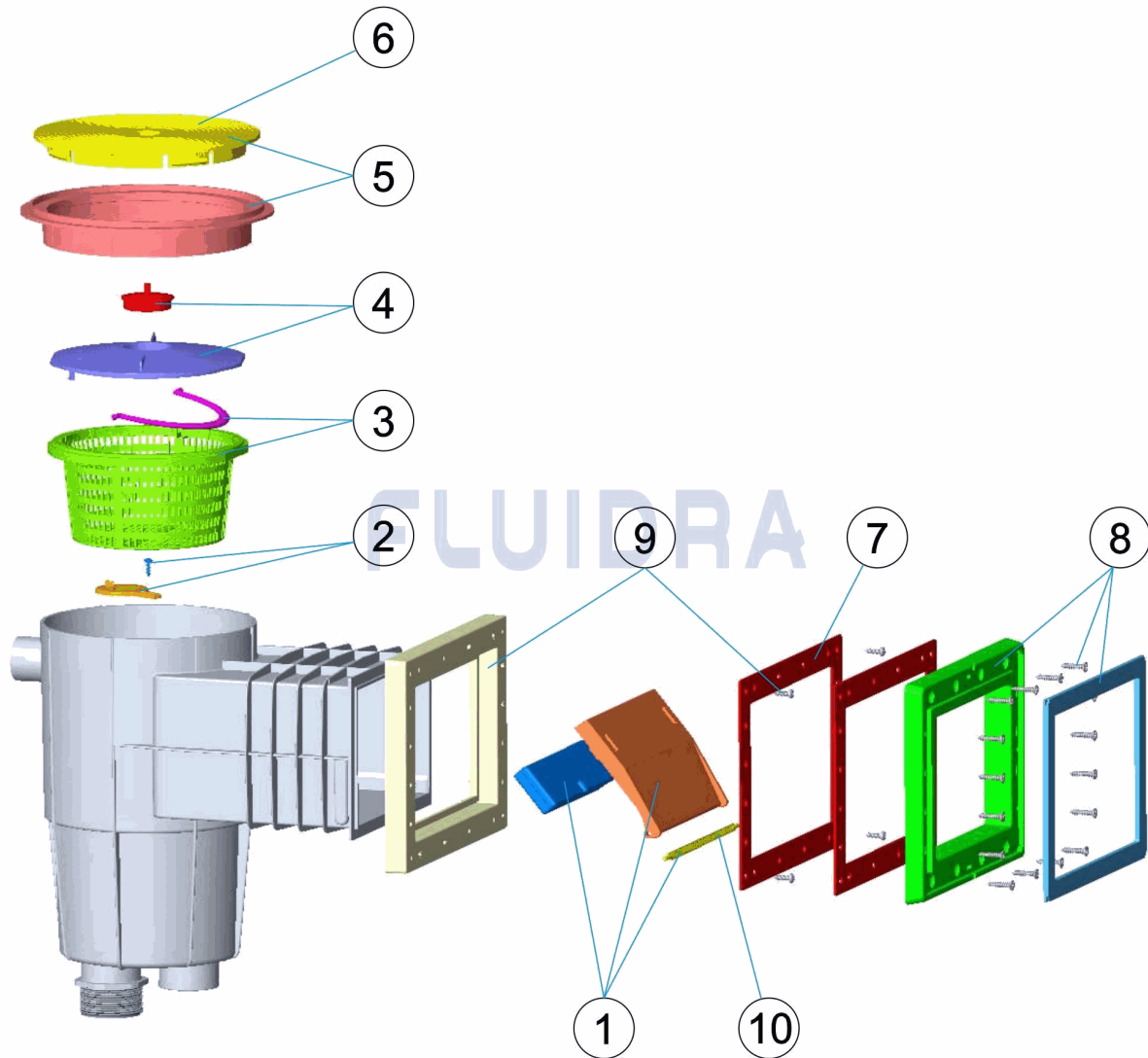

DEUTSCH

POS	CODE	BESCHREIBUNG	MENGE	POS	CODE	BESCHREIBUNG	MENGE
1	4402010101	SKIMMERKLAPPE SCHARNIER		6	4402010108	ABDECKUNG RUND SKIMMER	
2	4402010102	ABDECKKAPPE		7	4402010307	DICHTUNG SKIMMER KLEIN FERTIGBECKE	
3	4402010103	SKIMMERKORB		8	4402010312	KLEINER SKIMMERRAHMEN (PARKER)	
4	4402010104	ABDECKUNG SKIMMKORB MIT STOPFEN		9	4402010314	ADAPTERRAHMEN EINLASS (PARKER)	
5	4402010105	ABDECKUNG UND RING SKIMMER RUND		10	4402010110	SCHARNIER KLAPPE	

CODIGO **06471**

DESCRIÇÃO: **SKIMMER 15 L PP. B. STD. T. REDONDA TOR. PARKER**

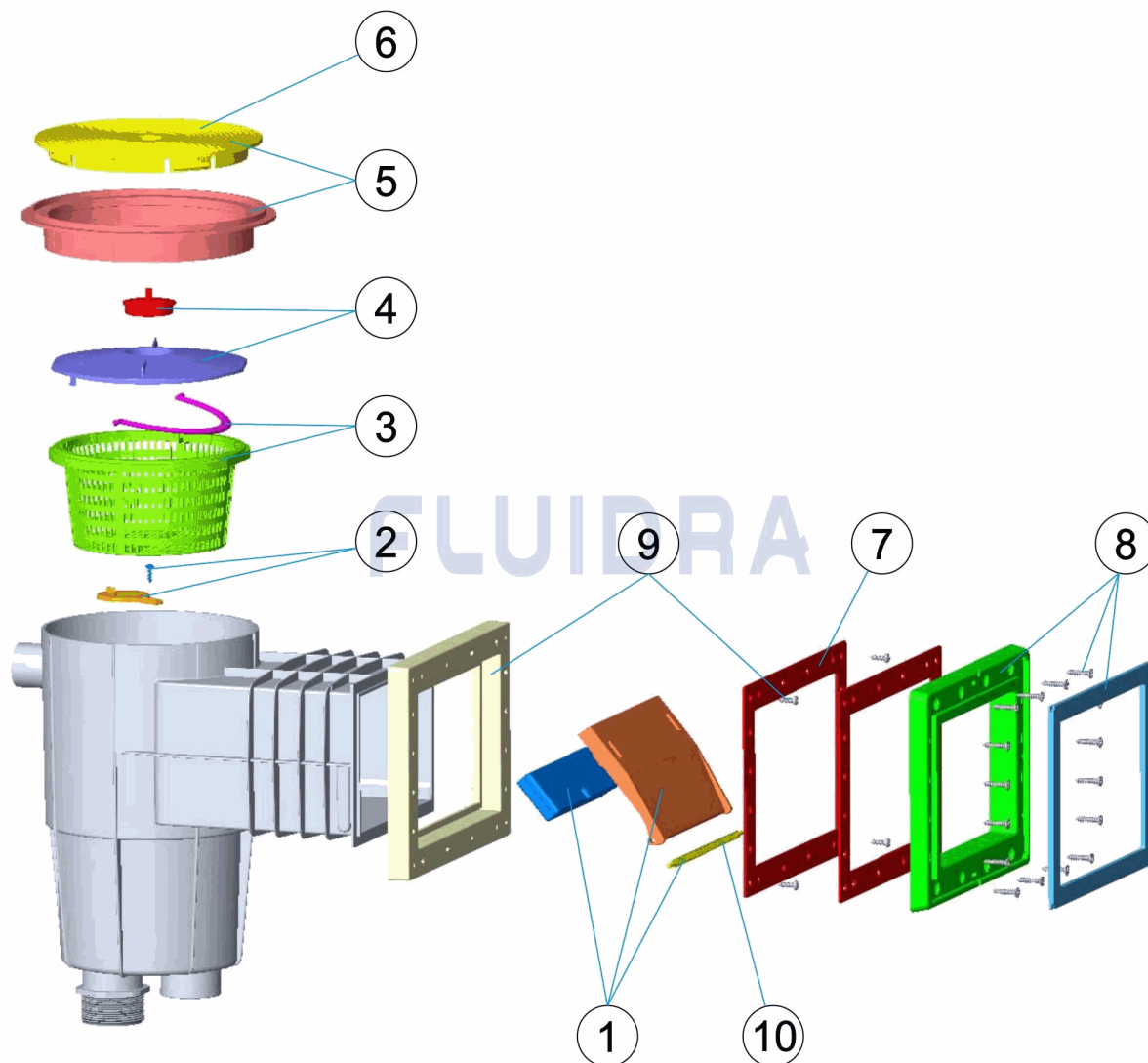

PORTUGUES

POS	CODIGO	DESCRIÇÃO	JANTIDADE	POS	CODIGO	DESCRIÇÃO	JANTIDADE
1	44020101	COMPORTA SKIMMER BISAGRA		6	4402010108	TAMPA CIRCULAR SKIMMER	
2	44020102	CLAPETA SKIMMER		7	4402010307	JUNTA PEQUENA DE SKIMMER	
3	44020103	CESTO SKIMMER		8	4402010312	CAIXILHO BOCA SKIMMER (PARKER)	
4	44020104	TAMPA CESTO SKIMMER		9	4402010314	CAIXILHO ADAPTADOR BOCA (PARKER)	
5	44020105	TAMPA E ARO CIRCULAR SKIMMER		10	4402010110	DOBRADIÇA COMPORTA	