

CODIGO **06472**

DESCRIPCION: **SKIMMER 15L B.ST. T.CUADRADA AUTOR.**

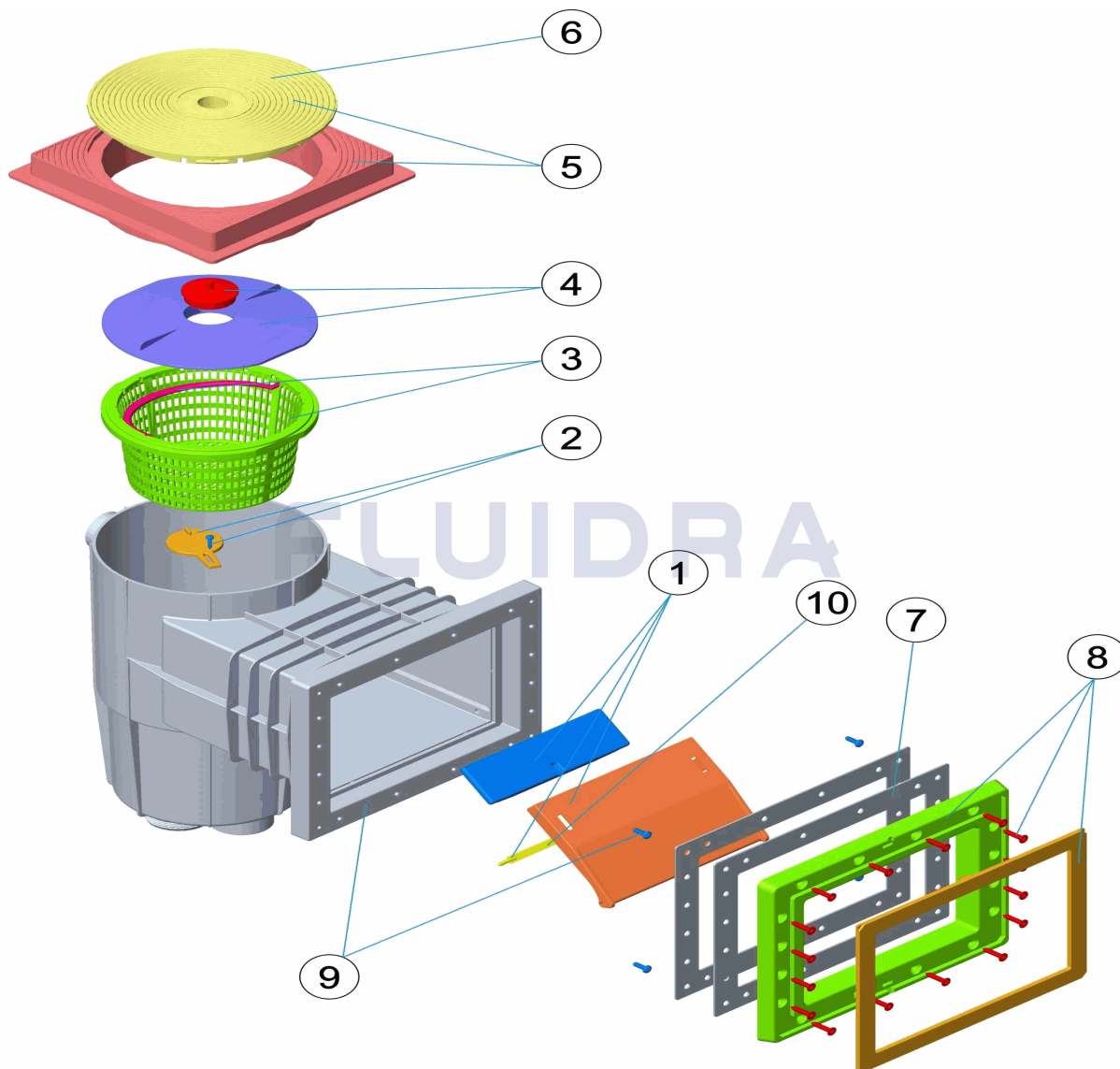

ESPAÑOL

POS	CODIGO	DESCRIPCION	CANTIDAD	POS	CODIGO	DESCRIPCION	CANTIDAD
1	44020101	COMPUERTA SKIMMER BISAGRA		6	4402010108	TAPA CIRCULAR SKIMMER	
2	44020102	CLAPETA SKIMMER		7	4402010307	JUNTA SKIMMER PEQUEÑA PISC. PREF.	
3	44020103	CESTO SKIMMER		8	4402010312	MARCO PEQUEÑO SKIMMER (PARKER)	
4	44020104	TAPA CESTO SKIMMER CON TAPON		9	4402010314	MARCO ADAPTADOR BOCA (PARKER)	
5	44020106	TAPA Y ARO CUADRADO SKIMMER		10	4402010110	BISAGRA COMPUERTA	

CODE 06472

DESCRIPTION: SKIMMER 15L B.ST. C.CARRÉ AUTOT.

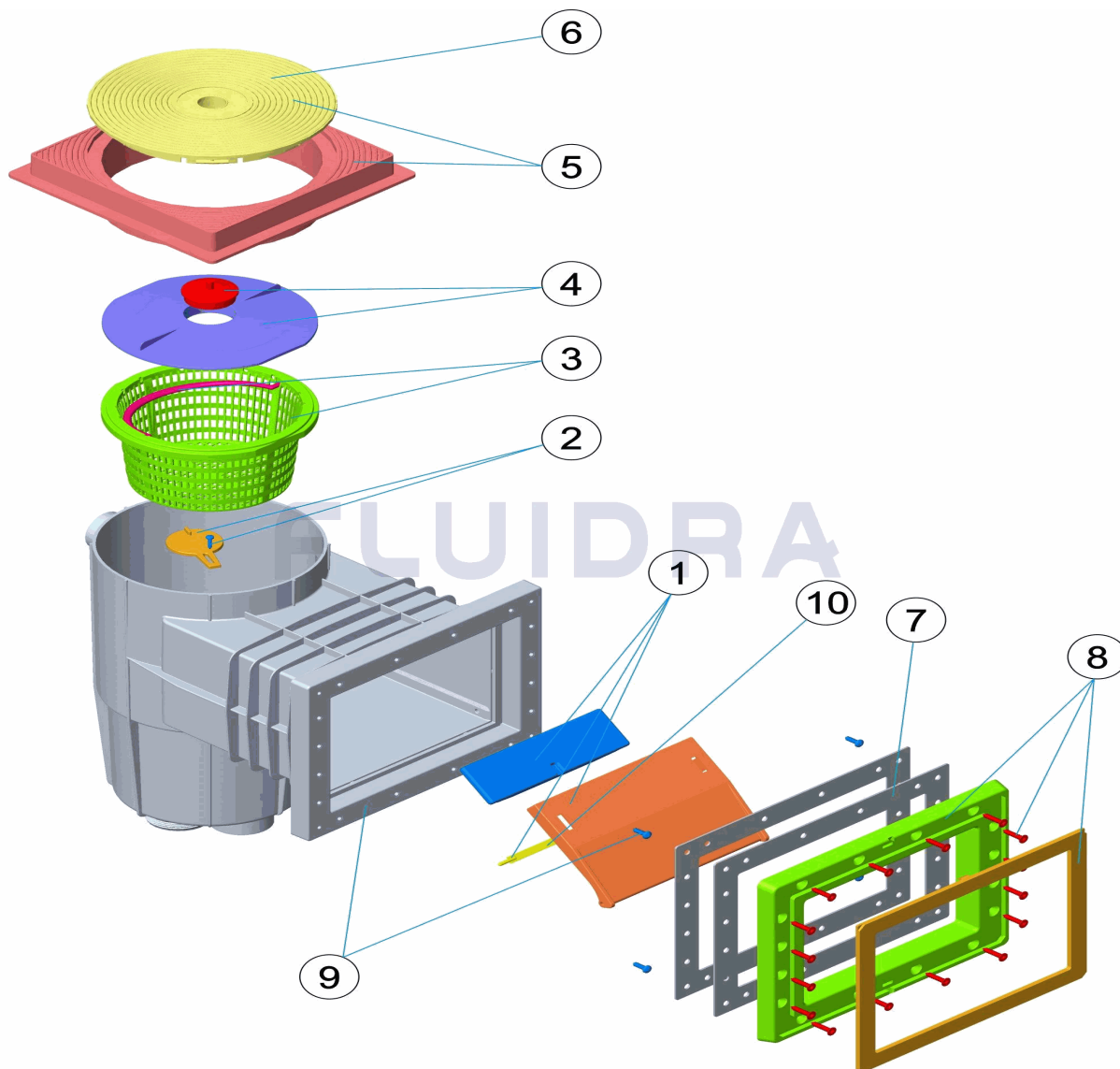

FRANCAIS

POS	CODE	DESCRIPTION	QUANTITE	POS	CODE	DESCRIPTION	QUANTITE
1	44020101	VOLET ET CHARNIERE SKIMMER		6	4402010108	COUVERCLE ROND SKIMMER	
2	44020102	CLAPET SKIMMER		7	4402010307	JOINT SKIM PETIT MODELE PISCINE LINER	
3	44020103	PANIER SKIMMER		8	4402010312	PETIT CADRE SKIMMER (PARKER)	
4	44020104	COUVERCLE PANIER SKIMMER AVEC BOU		9	4402010314	CADRE ADAPTEUR BOUCHE (PARKER)	
5	44020106	COUVERCLE ET CADRE CARRE SKIMMER		10	4402010110	CHARNIERE VOLET	

CODE **06472**

DESCRIPTION: **SQUARE SKIMMER 15L B.ST**

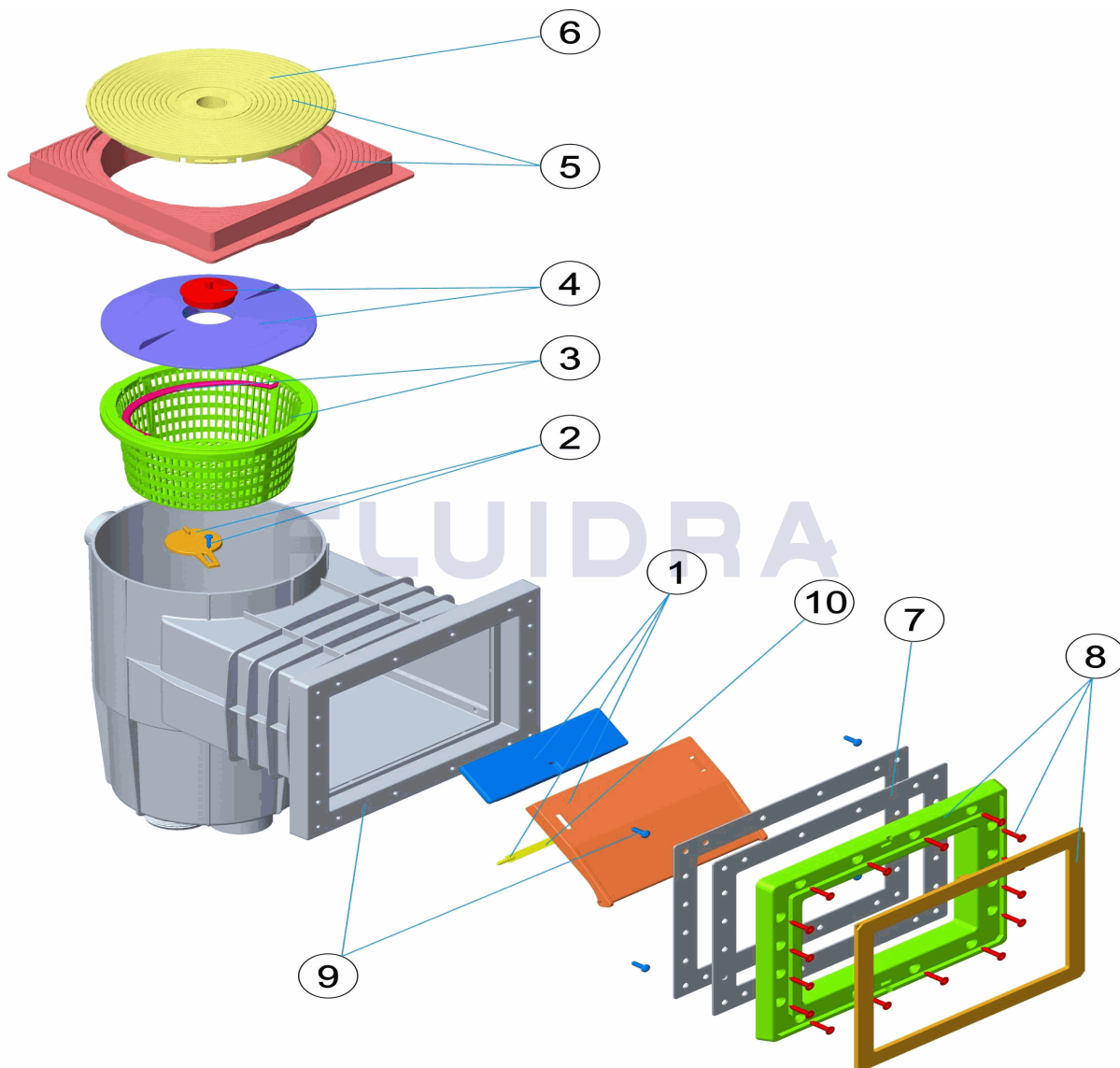

ENGLISH

POS	CODE	DESCRIPTION	QUANTITY	POS	CODE	DESCRIPTION	QUANTITY
1	44020101	FLAP RETAINING CLIP		6	4402010108	CIRCULAR SKIMMER LID	
2	44020102	KEYHOLE FLAP		7	4402010307	SMALL SKIMMER GASKETS FOR LINER PO	
3	44020103	SKIMMER BASKET		8	4402010312	SMALL SKIMMER FRAME (PARKER)	
4	44020104	VACUUM PLATE WITH PLUG		9	4402010314	ADAPTOR FRAME (PARKER)	
5	44020106	SQUARE LID AND LID FRAME		10	4402010110	HINGE FLAP	

CODICE 06472

DESCRIZIONE: SKIMMER 15L B. STD. TAPPO QUADRATO AUTOFILETTANTE

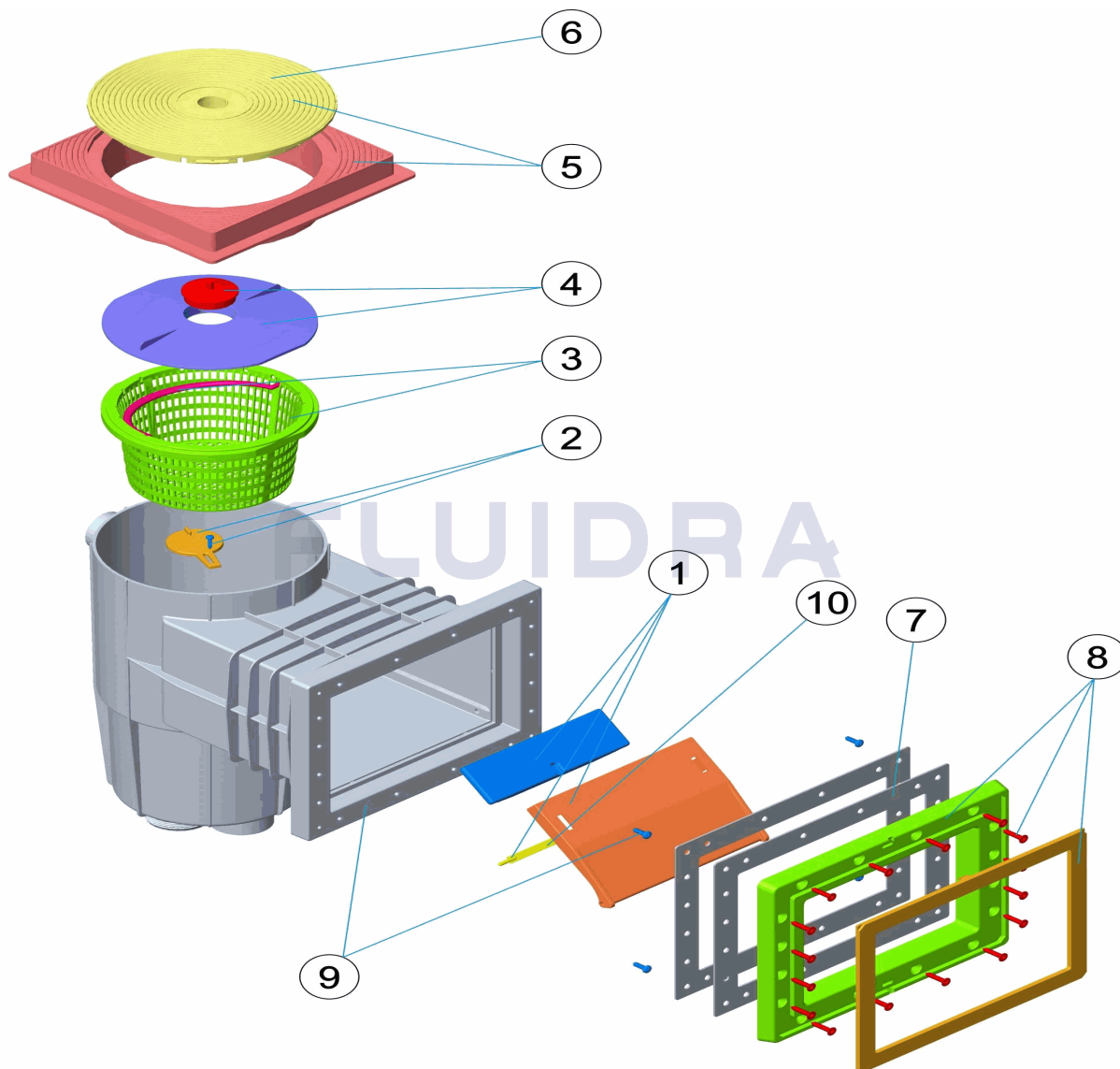

ITALIANO

POS	CODICE	DESCRIZIONE	QUANTITA'	POS	CODICE	DESCRIZIONE	QUANTITA'
1	4402010101	BATTENTE SKIMMER CON PERNO		6	4402010108	COPERCHIO TONDO SKIMMER	
2	4402010102	ALETTA PARZIALIZZATRICE SKIMMER		7	4402010307	GUARNIZIONE PER SKIMMER BASE P.F.	
3	4402010103	CESTELLO SKIMMER		8	4402010312	FLANGIA SKIMMER (PARKER)	
4	4402010104	COPERCHIO CESTELLO SKIMMER CON TA		9	4402010314	FLANGIA ADATTATORE BOCA (PARKER)	
5	4402010106	COPERCHIO E CORNICE QUADRA SKIMME		10	4402010110	CERNIERE BATTENTE	

CODE **06472**

BESCHREIBUNG: **SKIMMER 15L EINLASS STANDARD ABDECKUNG QUADRATISCH SELB**

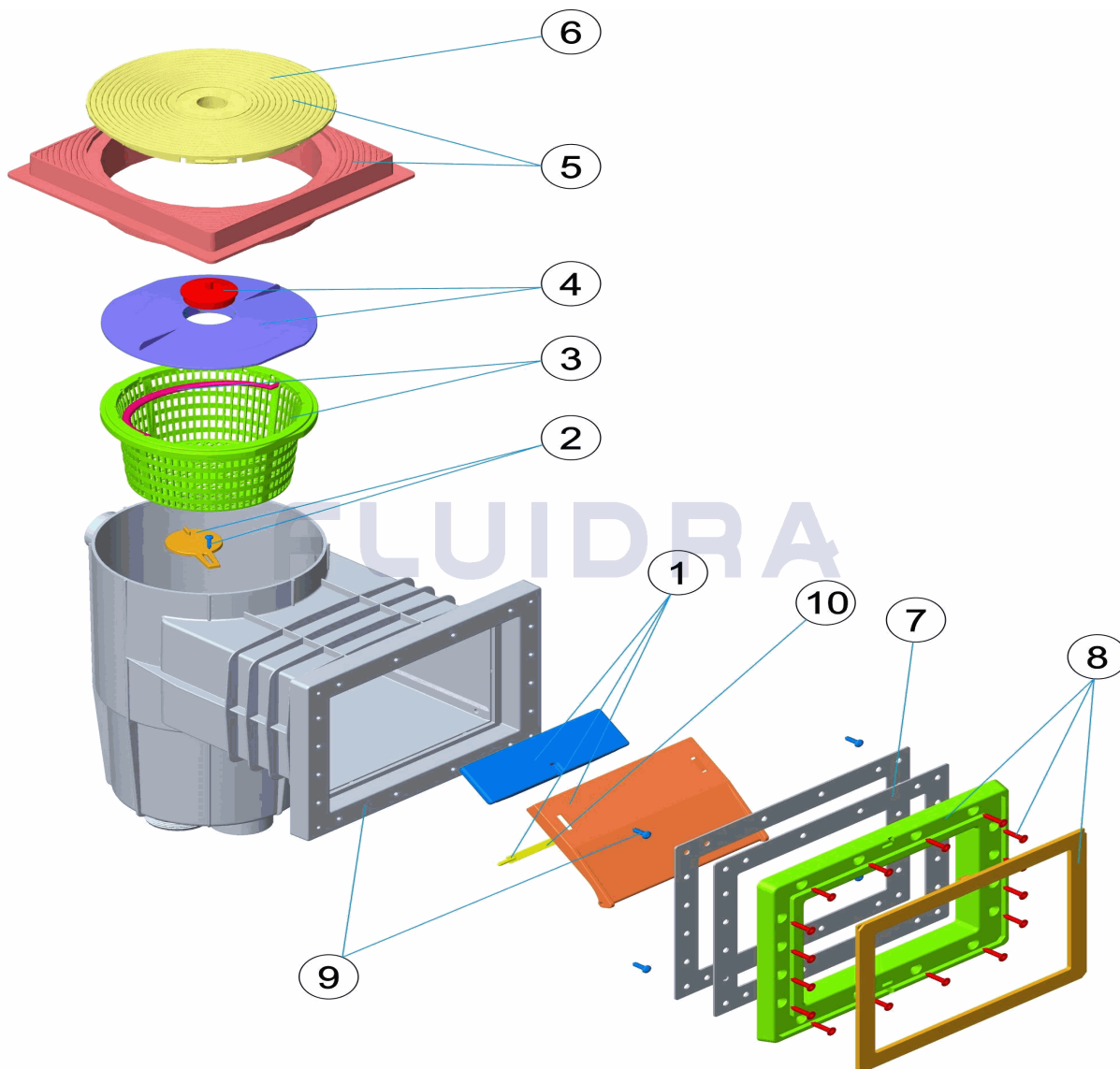

DEUTSCH

POS	CODE	BESCHREIBUNG	MENGE	POS	CODE	BESCHREIBUNG	MENGE
1	44020101	SKIMMERKLAPPE SCHARNIER		6	4402010108	ABDECKUNG RUND SKIMMER	
2	44020102	ABDECKKAPPE		7	4402010307	DICHUNG SKIMMER KLEIN FERTIGBECKE	
3	44020103	SKIMMERKORB		8	4402010312	KLEINER SKIMMERRAHMEN (PARKER)	
4	44020104	ABDECKUNG SKIMMKORB MIT STOPFEN		9	4402010314	ADAPTERRAHMEN EINLASS (PARKER)	
5	44020106	ABDECKUNG UND RING SKIMMER QUADR		10	4402010110	SCHARNIER KLAPPE	

CODIGO **06472**

DESCRIÇÃO: **SKIMMER 15 L B. ST. T. QUADRADA AUTOR.**

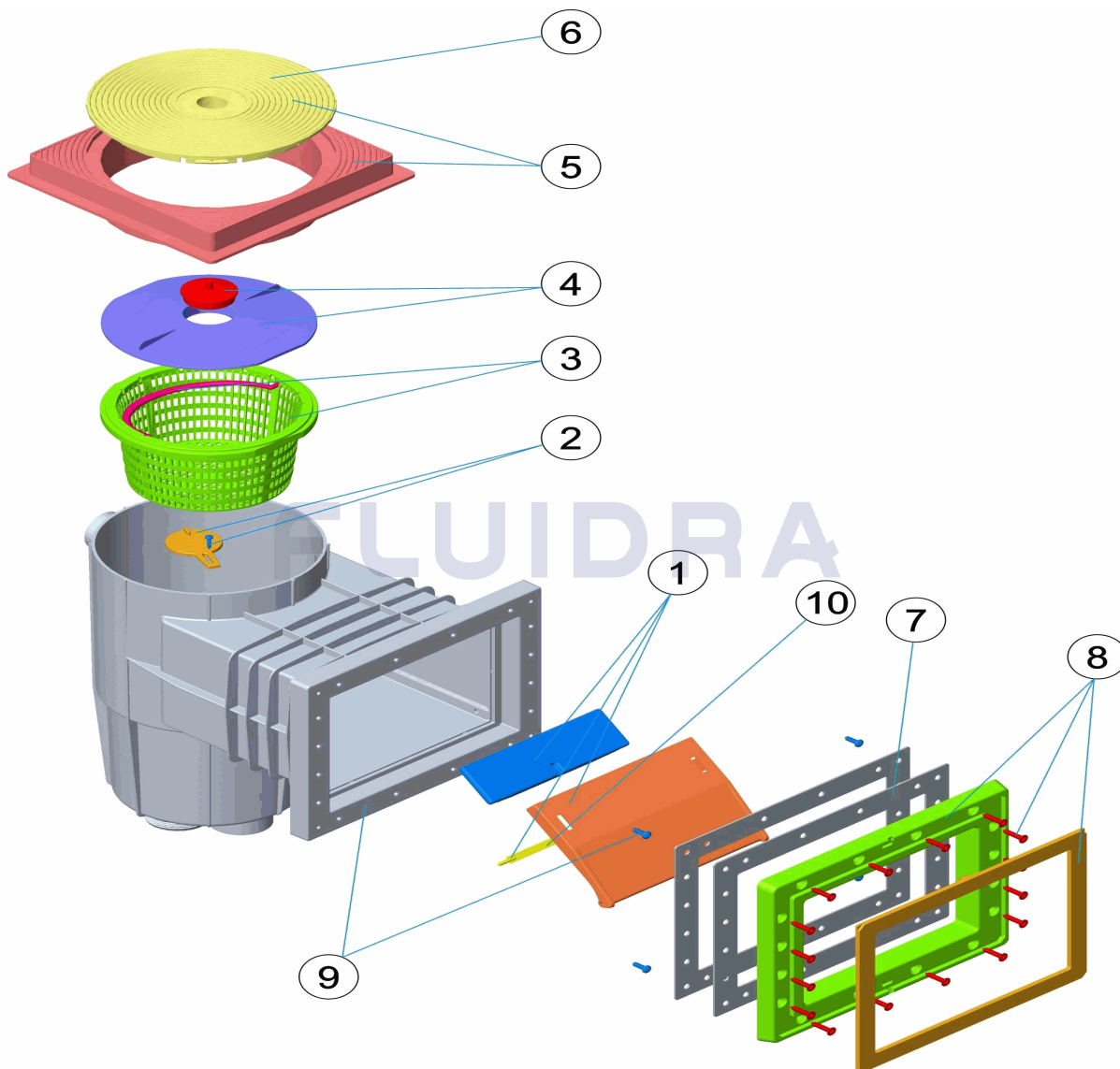

PORTUGUES

POS	CODIGO	DESCRIÇÃO	JANTIDADE	POS	CODIGO	DESCRIÇÃO	JANTIDADE
1	44020101	COMPORTA SKIMMER BISAGRA		6	4402010108	TAMPA CIRCULAR SKIMMER	
2	44020102	CLAPETA SKIMMER		7	4402010307	JUNTA PEQUENA DE SKIMMER	
3	44020103	CESTO SKIMMER		8	4402010312	CAIXILHO BOCA SKIMMER (PARKER)	
4	44020104	TAMPA CESTO SKIMMER		9	4402010314	CAIXILHO ADAPTADOR BOCA (PARKER)	
5	44020106	TAMPA E ARO QUADRADO SKIMMER		10	4402010110	DOBRADIÇA COMPORTA	